



*Your Corporate Real Estate Department<sup>sm</sup>*

## *New Office Building For Lease*

185 Express Street, Plainview, New York



Located immediately off the Long Island Expressway in Plainview, New York, 185 Express Street is a 26,540 square foot office building situated on a plot of 1.73 acres.

- 13,216 square feet of office space, divisible
- Offices custom built to tenant specifications
- Separate entrance and utilities for each tenant
- Low loss factor of 5%
- Fully sprinklered, sewers, gas heating
- Generous parking
- Immediately off the Long Island Expressway, Exit 46



Your Corporate Real Estate Department<sup>SM</sup>

## 185 Express Street, Plainview, NY

### Description:

26,540 square foot office building situated on 1.73 acres of land. Extensive parking. Completely renovated building includes all-new paving, landscaping, exteriors and custom-built office space to suit.

### Location:

Immediately off the Long Island Expressway, Exit 46. Minutes to the Seaford Oyster Bay Expressway, Route 110 and all major highways.

### Size:

13,216 square feet, divisible to smaller suites, each with an outside entrance door.

### Parking:

Generous, dedicated parking

### Occupancy:

60 to 90 days

### Rent:

\$22.95 gross plus metered utilities

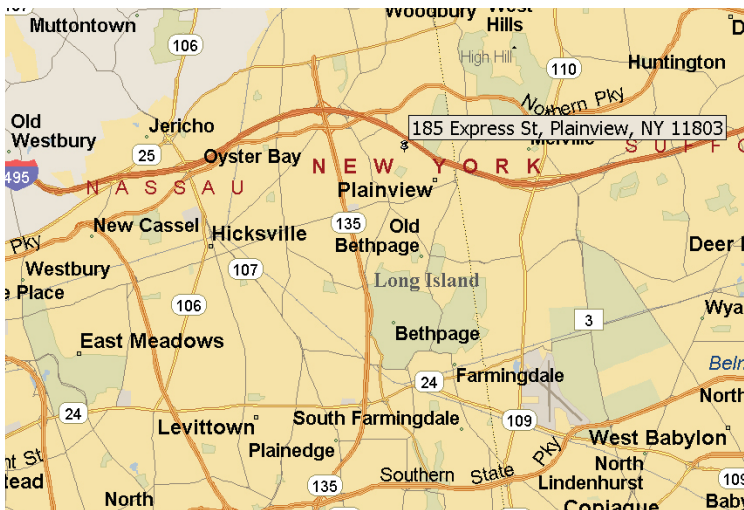
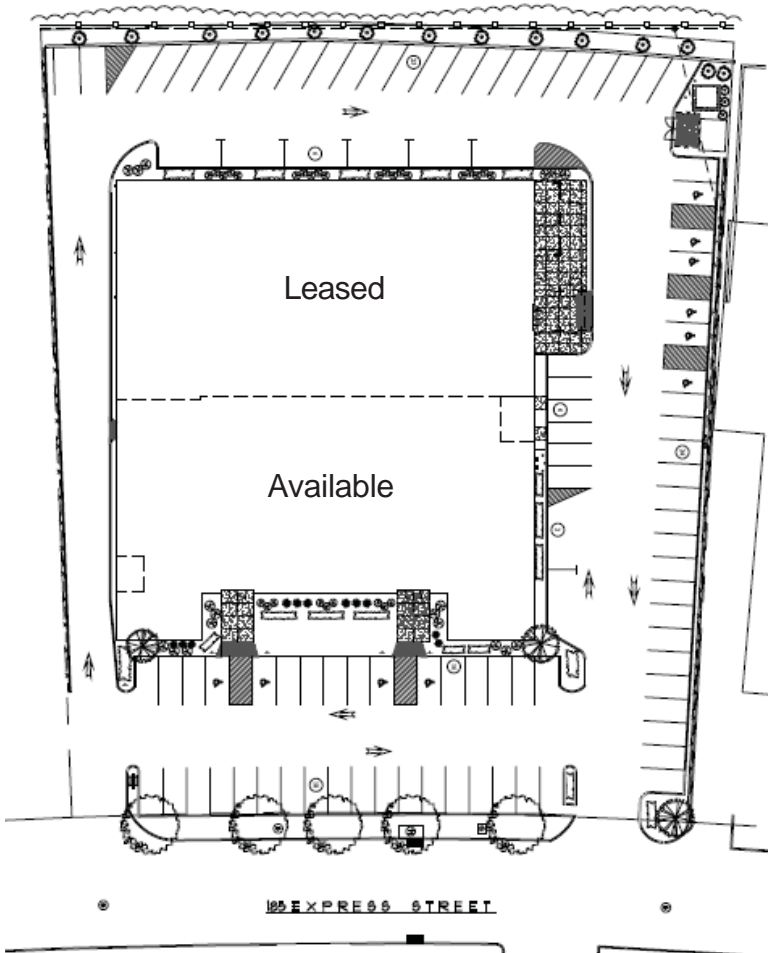

### For further information:

HUNT CORPORATE SERVICES, INC.  
17 Dupont St., Suite 4, Plainview, NY 11803-1614  
Tel: (516) 937-1000 • (800) 360-2250  
Fax: (516) 931-1850 • email@huntcorp.com  
www.huntcorp.com